

Universal Rail Overhead for K-9 Cages SC-929-5-K9

1/4

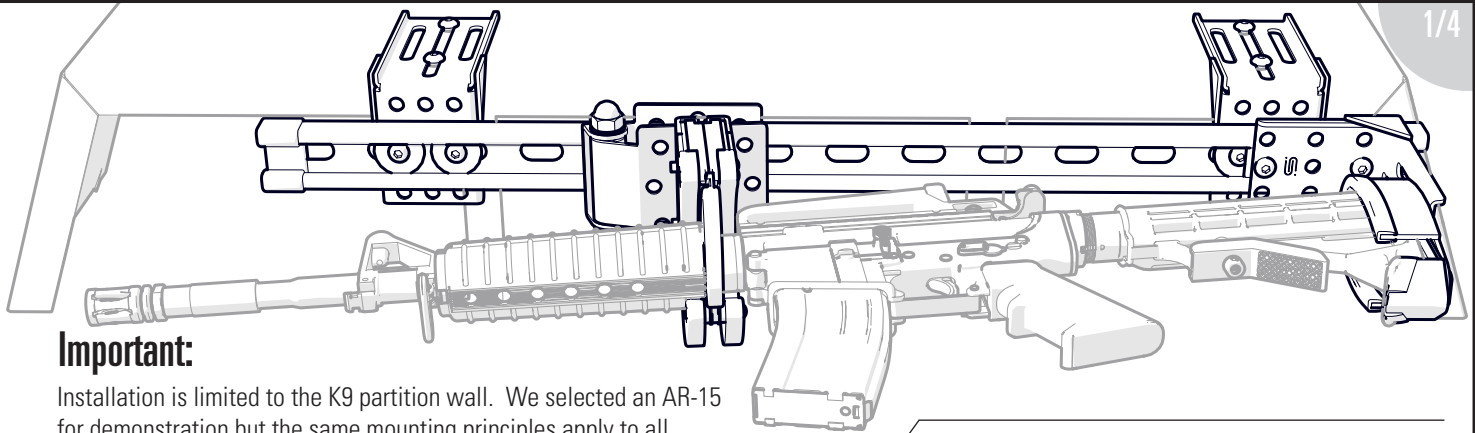

Important:

Installation is limited to the K9 partition wall. We selected an AR-15 for demonstration but the same mounting principles apply to all weapons (see pictures on the other side).

An adjustable overhead bracket installed on the partition wall that allows the use or exchange of any weapons in the setup.

Exploded view:

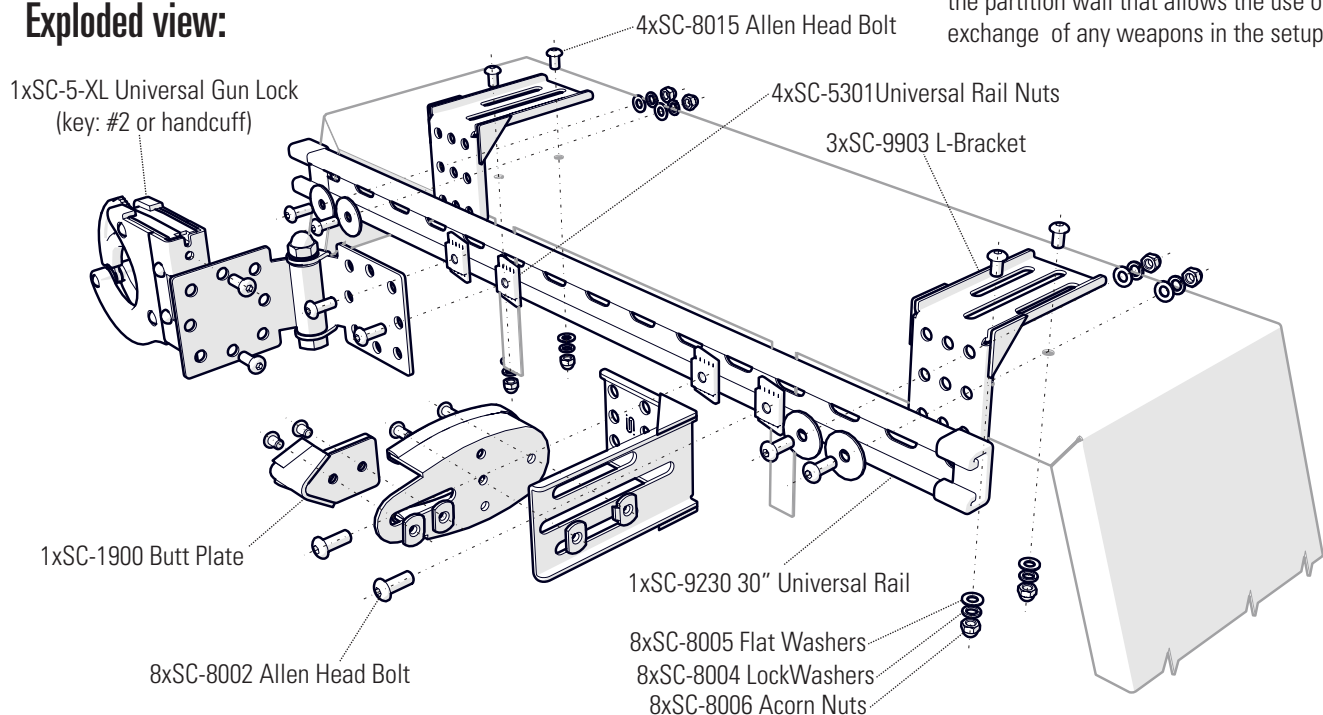

Components:

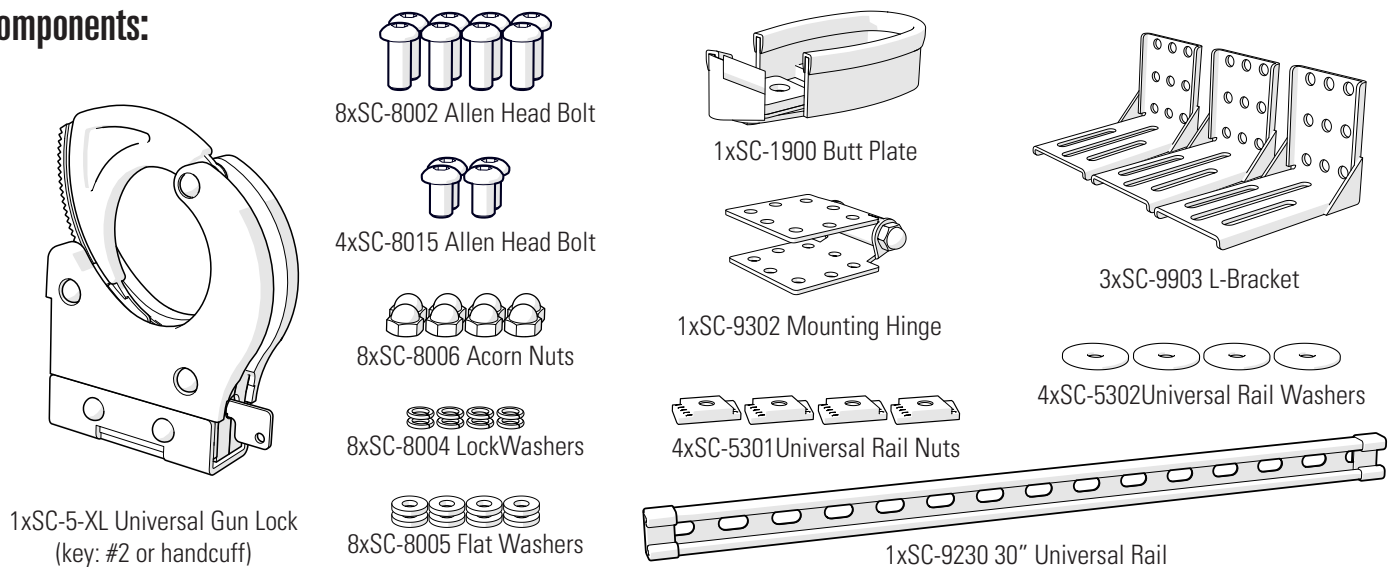

Universal Rail Overhead for K-9 Cages **SC-929-5-K9**

2/4

1 Muzzle Direction

Since our weapon racks are modular, this gives you the ability to have the weapon face with the muzzle pointing to either side of the vehicle.

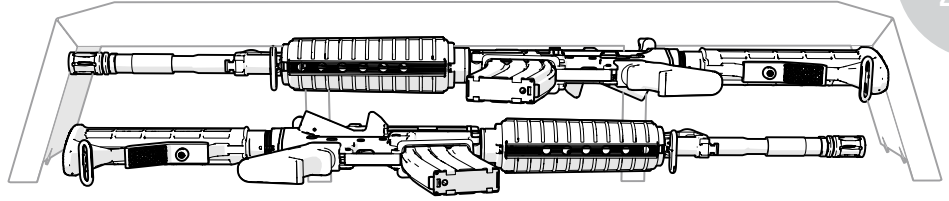

2 Install Bases

Install two L-Bracket (part No. SC-9903) onto the Universal Rail Nut (part No. SC-5301). Use the two large Universal Rail Washer (SC-5302)

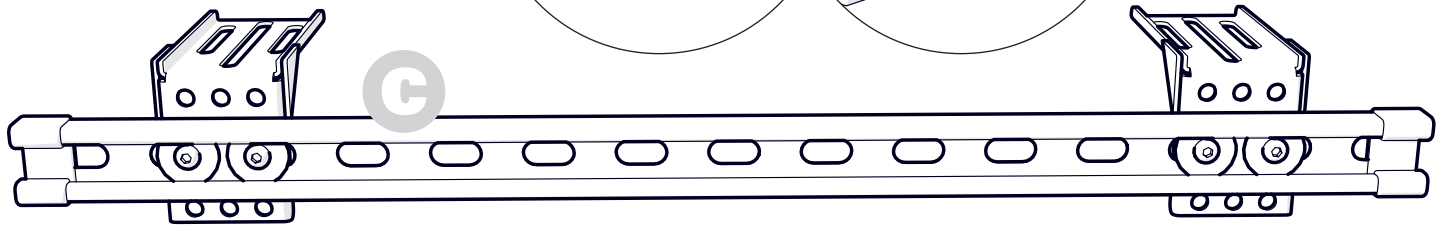
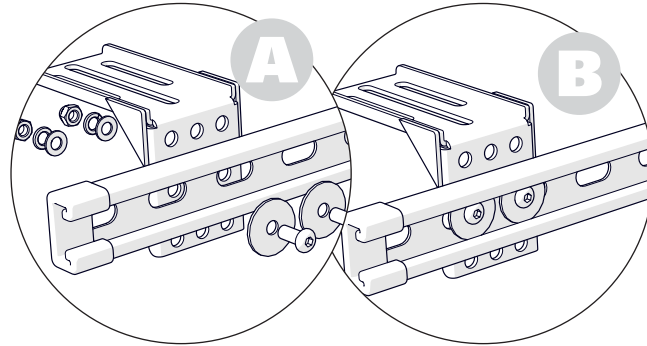

3 Install Buttplate

Install 2 x Universal Rail Nut (A) (part No. SC-5301) onto the "L" bracket (Part No. SC-9903). Tighten a little to allow sliding. Install the Butt Plate (part No. SC-1900) onto the "L" Bracket, using metal nuts and bolts of the Butt Plate. Since this is not the final installation, do not tighten bolts.

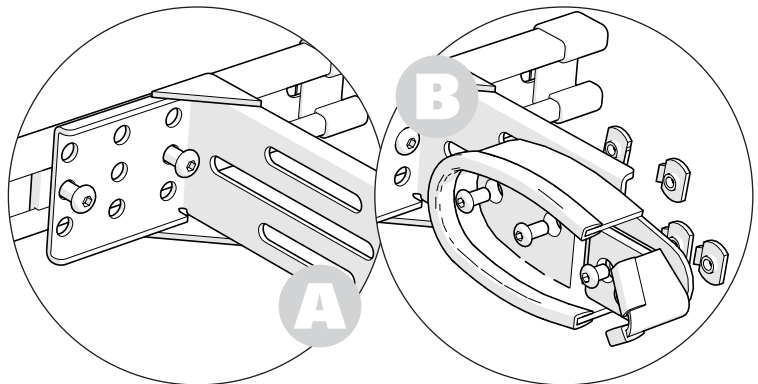

NOTE: If you have a weapon with larger optics on it, you can also mount the butt plate 90° downwards so that the optics will not interfere with the rack.

4 Install Gunlock

Install the Gunlock (SC-5-XL) for good onto Hinge (A)(part No. SC-9302). Install 2 x Universal Rail Nut (B) (part No. SC-5301) onto the Hinge. Drive the bolts into the two Rail Nuts with a few turns only, place it into the Universal Rail and tighten a little to allow free sliding.

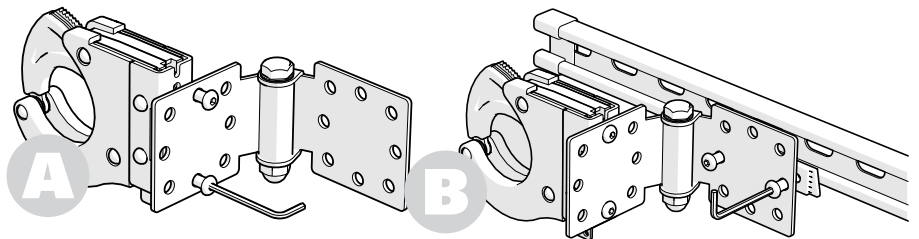

How to use the SC-5301 Universal Rail Nuts



Universal Rail Overhead for K-9 Cages SC-929-5-K9

3/4

5 Adjust the parts

Slightly tighten all bolts and screws so you can still move parts around. Put your actual weapon in the gun lock and butt plate and position your whole assembly at your intended location. Adjust hinge height/angle and butt plate position until your weapon is properly lined up. If you close the ratchet arm tightly on your firearm, you will have to press or tap the outer rubber surface of the ratchet arm when deploying the firearm. Assemble the setup on the table and if the gun is in its proper position and measure the location of U Bolts. When measurements are completed, mark the position of the "L" Bracket and the Hinge on the Universal Rail and remove the two Roll Bar Base.

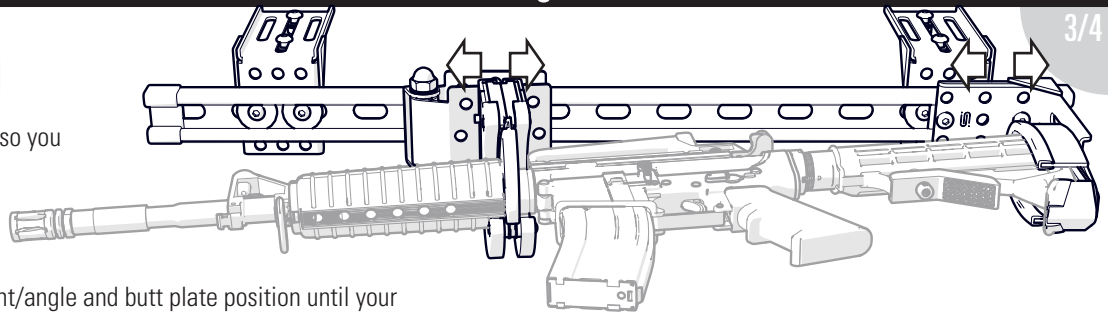

6 Mark the brackets

Mark the position of L brackets (as measured above) on the back of the partition wall pipe.

Warning: after installation the gun must have enough room under the ceiling with leaving room on both sides.

Note: be certain that L brackets do not interfere with the K9 cage door if applicable.

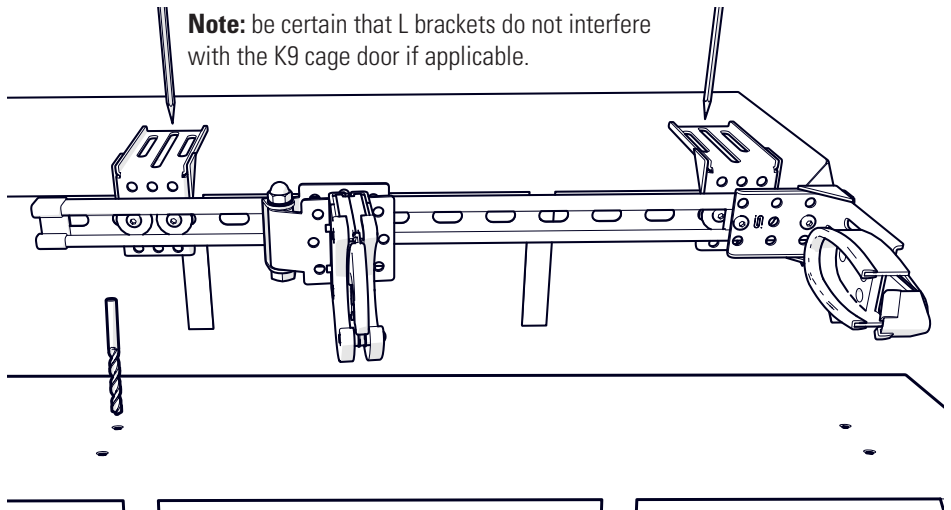

7 Drill and install

Drill your holes and install assembly.

6 Mount Bases

Mount all brackets and hardware as shown. Hand tighten all of the hardware.

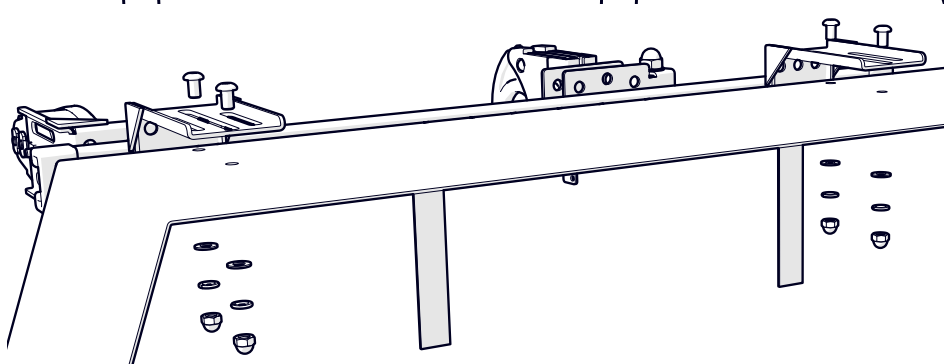

9 Tighten the screws

Tighten all of the hardware and test rack to make sure that there is not any interferences. If applicable, test the K9 cage door to be sure that it opens. Make any necessary adjustments.

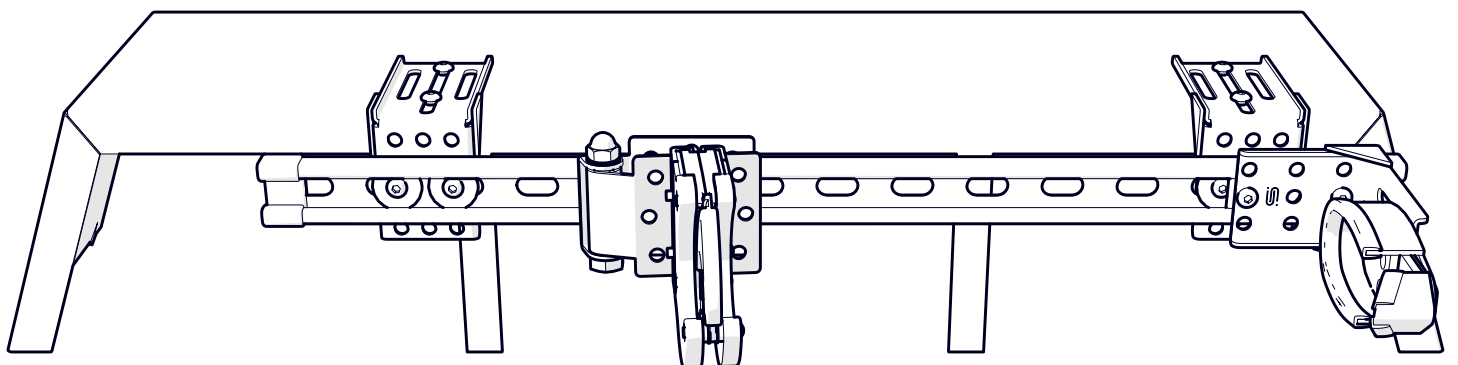

Universal Rail Overhead for K-9 Cages SC-929-5-K9

4/4

Important

Should you have any problem installing or using Santa Cruz products, we are here to help you every step of the way. Just give us a call at our toll free number (800) 847-5428 and we will be glad to help you with the installation, special part request or any other way you might need assistance.

WARNING! SAFETY FIRST! Gunlock Safety Precautions



NOTE:

Santa Cruz Gunlocks, LLC (SCG) gun racks and gunlocks are intended for temporary, secure storage of firearms. They are not substitutes for a permanent storage enclosure and only act as limited theft deterrents. And they will not prevent accidental discharge/firing of a chambered round.

To properly and safely use the SCG gun rack and/or gunlock:

- Do not use if your firearm does not fit the SCG gun rack and/or gunlock
- Never leave your firearm unsupervised while using a SCG gun rack and/or gun lock
- Never place a loaded firearm in a SCG gun rack and/or gun lock
- Never chamber a round while using a SCG gun rack and/or gunlock
- It is the responsibility of the user to operate the SCG gun rack and/or gunlock properly and safely

Santa Cruz Gunlocks, LLC. (SCG) warrants this product to be free of defects in material and workmanship under normal use for one year from the date of purchase.

SCG makes no other express or implied warranties of the product. The purchaser's sole and exclusive remedy in the unlikely event of breach of warranty is expressly limited to, at SCG's election, repair, refurbishment, or replacement of the defective product with the same version or an upgrade or, if replacement is not possible, a refund of the purchase price.

Shipping cost to SCG must be paid by the user and SCG will pay return shipping charges. Repair parts and replacement products will be provided on an exchange base only and will be either reconditioned or new. This limited warranty does not cover damage to the product resulting from accident, disaster, misuse, abuse, negligence, improper installation or modification or repair of the product other than by SCG. Limited warranty service may be obtained by returning the product to SCG. THIS LIMITED WARRANTY IS IN LIEU OF ALL OTHER WARRANTIES, EXPRESS OR IMPLIED, INCLUDING, BUT NOT LIMITED TO, THE IMPLIED WARRANTIES OF MERCHANTABILITY AND FITNESS FOR A PARTICULAR PURPOSE. Some states, do not allow the exclusion of implied warranties, so their exclusion above may not apply to you.

LIMITATION OF LIABILITY

NEITHER SCG NOR ITS AUTHORIZED DEALER(S) SHALL BE LIABLE FOR ANY DIRECT, INDIRECT, INCIDENTAL, SPECIAL, OR CONSEQUENTIAL DAMAGES, WHETHER IN AN ACTION IN CONTRACT OR TORT (INCLUDING NEGLIGENCE AND STRICT LIABILITY), SUCH AS, BUT NOT LIMITED TO, LOSS OF ANTICIPATED PROFITS OR BENEFITS RESULTING FROM THE USE OR NOT USE OF THE PRODUCT OR ANY BREACH OF ANY WARRANTY, EVEN IF SCG OR ITS AUTHORIZED REPRESENTATIVE HAS BEEN ADVISED OF THE POSSIBILITY OF SUCH DAMAGES. IN NO EVENT WILL SCG OR ITS AUTHORIZED REPRESENTATIVES' LIABILITY EXCEED THE PRICE PAID FOR THE PRODUCT.

Tamper resistant hardware (optional)



8x Tamper Resistant
Torx Head Bolt
5/16-18

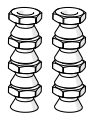

8x Tamper Resistant
Break Away Nut 5/16-18



TT-40 Torx Bit

Tools needed for installation

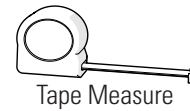

Tape Measure

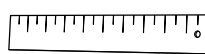

Ruler



3/16" Hex Wrench

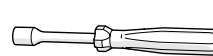

Nutdriver

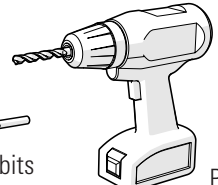

Drill



Drill bits
5/16", 21/64"



Pencil

Note:

