

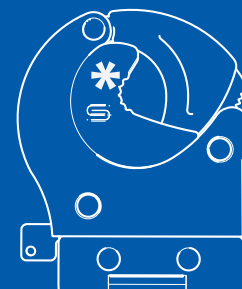

SC-6 GUNLOCK

NEW FEATURES:

Barrel or Buffer Tube Insert
Extending Pawl
Hook & Groove Design
Anti-Shim Star Wheel
Solenoid



New Features SC-6



Barrel & Buffer Tube insert

Gain additional versatility with the durable SC-6060 Thermal Plastic Elastomer insert designed specifically for securing the barrel or buffer tube of your firearm.

Extending Pawl:

Patented three tooth pawl provides strengthened locking action during forced opening attempts.

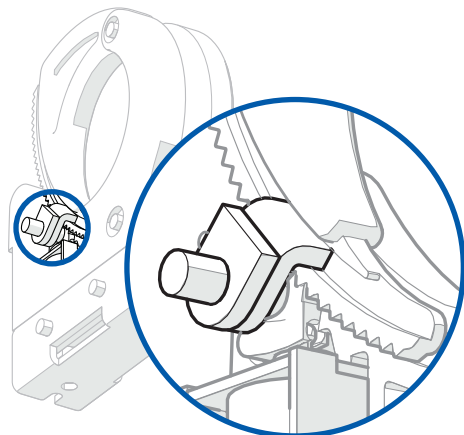

Hook & Groove Design:

Connection between the stainless steel hook in the lock body and the stainless steel ratchet arm ensure lock cannot be ripped open with manual force. Forced opening tests show the SC-6 can withstand over 1900 ft-lb of force.

Solenoid:

Next generation solenoid cannot be opened with a 9V battery.

Anti-shim Star Wheel:

Patented cog design shields latching mechanism from attempts at "shimming".

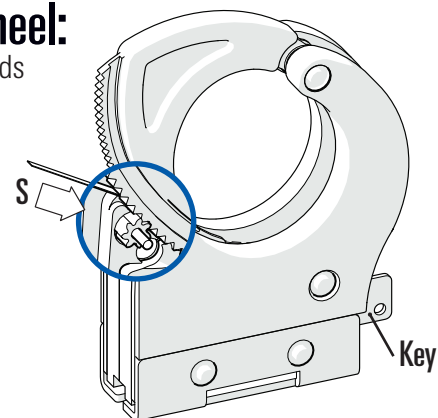

5 Different Key Options Available

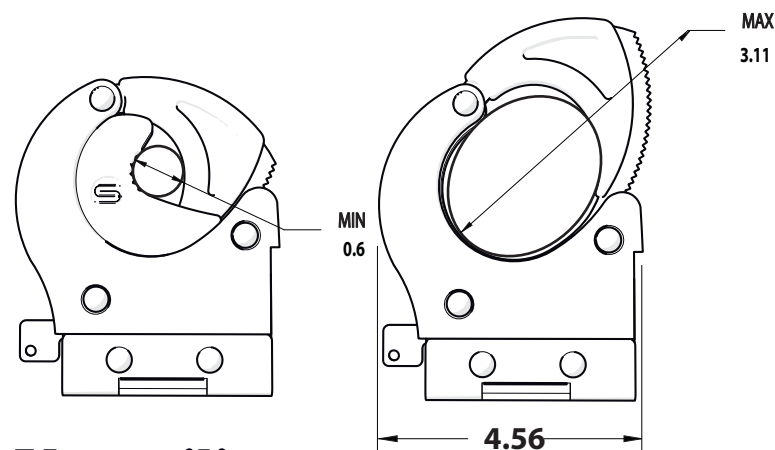

Versatility:

Adjustability in locking diameter allows the SC-6 to secure patrol rifles, pump shotguns, semi-auto shotguns, and a wide range of tools and specialty firearms.

